

# LONGREACH REGIONAL COUNCIL ORDINARY MEETING AGENDA

**Thursday 17 September 2020**

*Ilfracombe Recreation Centre, Ilfracombe*

## LATE ITEMS

**15. Late Items**

15.1 Request to construct a shade skillion at the Yaraka Playground.....1

## 15. LATE ITEMS

### 15.1 - Request to construct a shade skillion at the Yaraka Playground.

#### 15. LATE ITEMS

#### 15.1 Request to construct a shade skillion at the Yaraka Playground.

File Ref:

Consideration of a request from the Yaraka Sports and Progress Association to construct a shade skillion over the playground.

#### Council Action

Deliver

#### Applicable Legislation

Local Government Act 2009

#### Policy Considerations

Nil

#### Corporate and Operational Plan Considerations

COMMUNITY AND CULTURAL: PUBLIC FACILITIES			
Link to Corporate Plan	Activity	Key Performance Indicators	Operational Targets
4.2.1	Maintain and repair facilities in accordance with approved budget.	Achieve annual maintenance budget and program.	Achievement of maintenance program and operational expenditure within >95% - <102%
4.2.1	Deliver the annual capital & one-off works program	Achieve annual capital & one-off works program.	Achievement of capital expenditure budget delivered on time and at or <100% of budgeted cost.

#### Budget Considerations

\$5000 from the Longreach Regional Council Community Donations Program (if approved)

#### Previous Council Resolutions related to this Matter

Nil

#### Officer Comment

**Responsible Officer/s:** Lisa Young, Director of Community & Cultural Services

#### Background:

The Yaraka Sports and Progress Association (YSPA) previously approach Council for the installation of a birds nest swing as an addition to their playground. This was approved. At the 2019 community consultation, it was discussed with the community about the non compliance issues with the existing playground and if funding was to come up, Council look to replace the playground. In this replacement, a birds nest swing would be considered.

During that period, the YSPA also proactively applied for external funding to support the construction of a shade structure for the birds nest swing – which was approved.

Given the change in circumstances and the fact Council has scheduled a full replacement of the non compliant playground, inclusive of a birds nest swing, the YSPA is requesting permission for a shade skillion to be constructed on an existing shed.

## 15. LATE ITEMS

### 15.1 - Request to construct a shade skillion at the Yaraka Playground.

---

The shelter would be to improve shade on the new playground which will be installed in late November, and would provide a sheltered place for parents to sit and watch their children.

The YSPA are also asking for community funding from the Longreach Regional Council to the value of \$5000, which would supplement existing grant money that they have received from the QLD Cancer Council. This application would be submitted, pending Council approval to build the structure.

#### **Issue:**

The proposed skillion is 6m x 3.5m and the existing shed is 12m x 8m. The proposed skillion would only cover half the length of the shed (as shown in the attached diagram). While Council Officers commend the efforts of the progress group in obtaining the funding, it would be good to address the aesthetic look of the final product, Council's Officers recommend that further investigation be undertaken to obtain costs for a structure which will extend the whole length of the shed and Council consider providing gap funding as part of the playground upgrade.

The grant money from the QLD Cancer Council has to be expended by December otherwise it is to be returned. Council Officer's contacted the builder that the YSPA have consulted with about the proposed structure. Advice from the builder was that the structure could take up to 8 weeks to arrive from the date ordered due to the delays caused by COVID-19. The wait time is usually 4-6 weeks.

#### **Risk Management Factors:**

This matter has been assessed using Council's Risk Matrix to decide the likelihood and consequence of any risk to Council:

Likelihood: Unlikely  
Consequence: Insignificant

#### **Environmental Management Factors:**

Nil

#### **Other Comments:**

If approved by Council, a building application is required to be lodged. The building fees would be \$1361.

#### **Appendices**

1. Project Support Request.pdf
2. Yaraka Proposed Shade Shed Extension Plan No 1.pdf
3. Yaraka Proposed Shade Shed Extension Plan No 2.pdf

#### **Recommendation:**

1. That Council investigate options for the installation of shade at the Yaraka Playground.
2. That Council request a date for consultation with the Yaraka Sports and Progress Association to discuss options and costs.
3. That a report be presented to Council in the October Ordinary Meeting for resolution.



# Project Support Request

## ORGANISATION DETAILS

Name of Organisation	Yaraka Sports and Progress Association
ABN	81 723 356 703
Contact Person	Susan Glasson
Position held	President
Phone	0428575532
Email address	hsglasson3@bigpond.com
<p>Organisation</p> <p>Vision/Mission</p>	<p>Yaraka Sports and Progress Association is concerned for the improvements and liveability in the town and district. The Yaraka Sports &amp; Progress Association is responsible for the following:</p> <ul style="list-style-type: none"> <li>· Organization of community social and sporting events.</li> <li>· Liaising with Longreach Regional Council on community infrastructure, liveability and sustainability.</li> <li>· Catering at community functions.</li> <li>· Liaising with charitable groups visiting the town who require catering &amp; accommodation</li> <li>· Administering funds received from catering and funds received through grants.</li> <li>· Managing the school building which is used as an educational facility and for volunteer groups accommodation</li> <li>· Managing the community troop carrier which is used to ferry the Royal Flying Doctor Service crew and also used for transport at community events</li> </ul>



# Project Support Request

## PROJECT DETAILS

Title of Project	<b>Shade Skillion at Playground</b>
Project Description	The erection of a 6mX3.5m colourbond shade skillion to go along side an existing shed over the playground. This shelter would improve shade on the newly installed playground and would provide a sheltered place for parents to sit and watch their children.
Address of Project	<b>Yaraka hall , Jarley St Yaraka</b>
Type of project	<input type="checkbox"/> Infrastructure <input type="checkbox"/> Community Activity/Program <input type="checkbox"/> Community Event
Value of Project	<b>\$10,000</b>
Land Owned by	<b>Longreach Regional Council</b>
Support requested from Council	<input type="checkbox"/> Letter of Support <input type="checkbox"/> In-kind support <input checked="" type="checkbox"/> Financial support <input checked="" type="checkbox"/> Permission to undertake project on council property <input type="checkbox"/> Waive council fees



# Project Support Request

## PROJECT DETAILS (cont)

Details of support requested from Council	Permission for the new shed to be erected. Consideration of community funding from Longreach Regional Council to the value of \$5000 which would supplement a grant received by the Yaraka Sports and Progress Association
Project duration	<b>3 months</b>
Outline the need for this project	There is presently no where close to the playground, out of the sun, for parents to sit and watch their children.
Who is the target group for this project	Local children and parents Visiting children and parents
If this is an infrastructure project please outline who will be responsible for maintenance	Longreach Regional Council

15.1 - Request to construct a shade skillion at the Yaraka Playground. --Appendix 1

---

If this is an infrastructure project please outline if development and building approval has been sought	Not yet as Council approval hasnt been given.
Annual estimate for maintenance	Nil
If this is an infrastructure project who will be responsible for managing construction	Longreach Regional Council and Yaraka Sports and Progress Association

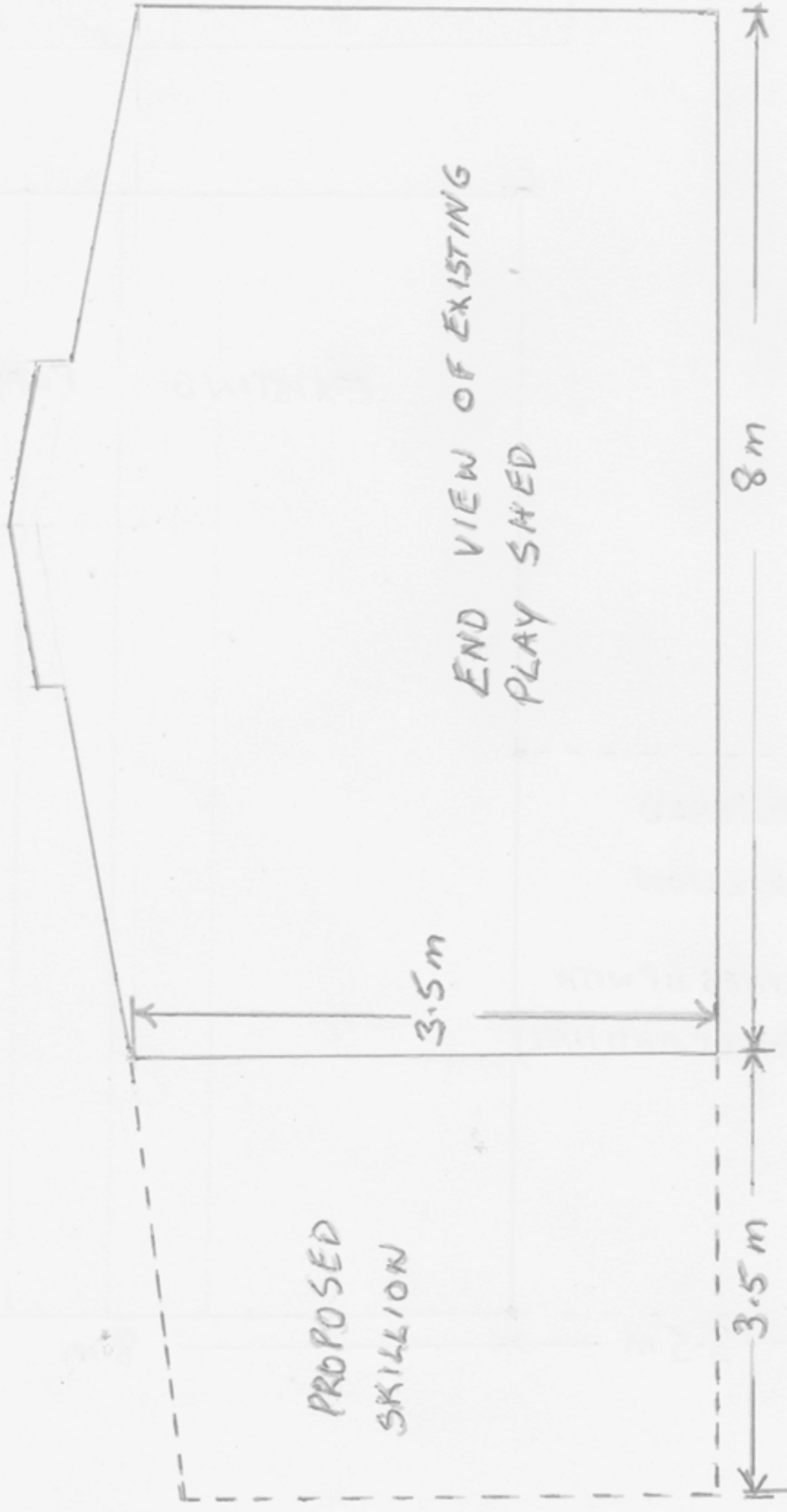

YARAKA



